

**Floor plans:**  
low density,  
only 186 units,  
6 units per  
floor.

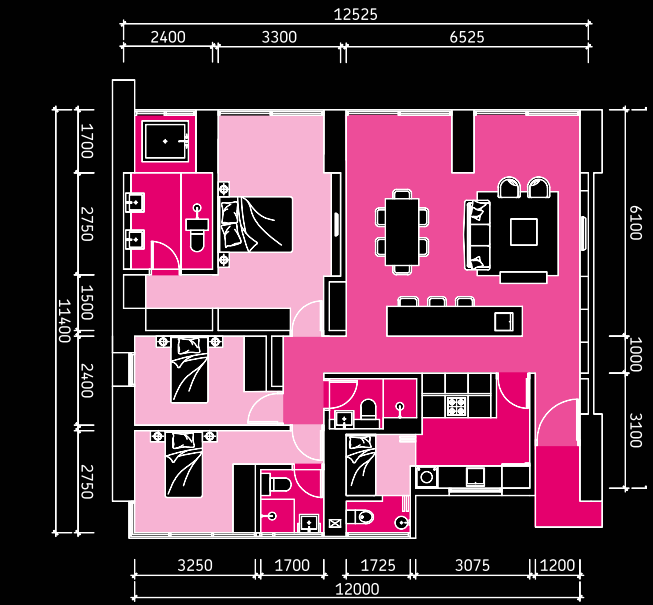

**UNIT TYPE C**  
3 BEDROOMS • 1,509 SQ FT  
FULL BALCONY

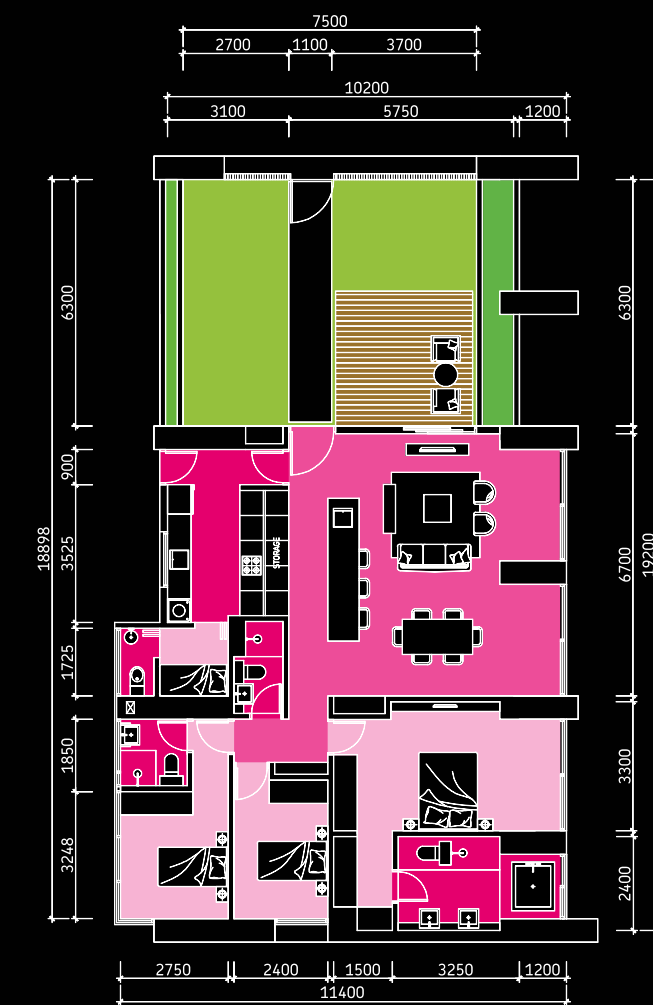

**UNIT TYPE C1**  
3 BEDROOMS • 2,218 SQ FT  
FULL BALCONY + GARDEN

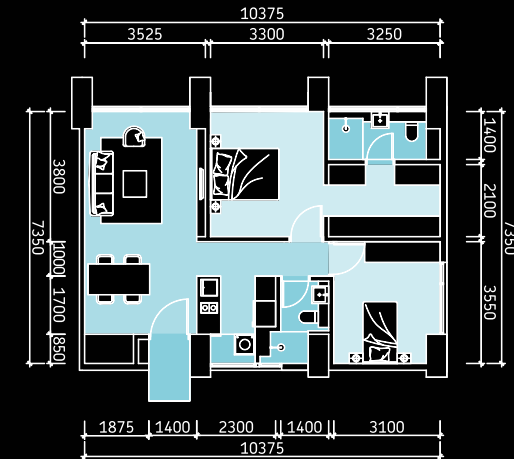

**UNIT TYPE A**  
2 BEDROOMS • 862 SQ FT  
NO BALCONY

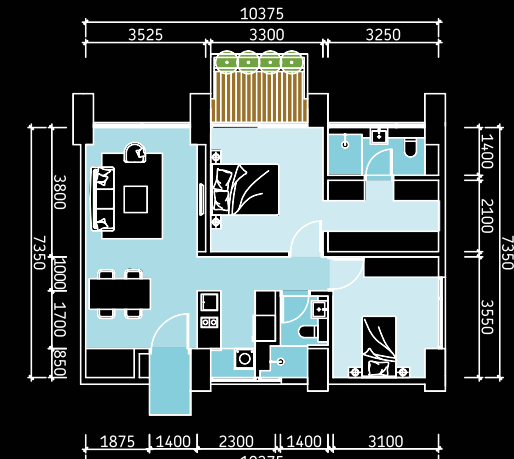

**UNIT TYPE A1**  
2 BEDROOMS • 920 SQ FT  
1 BAY BALCONY

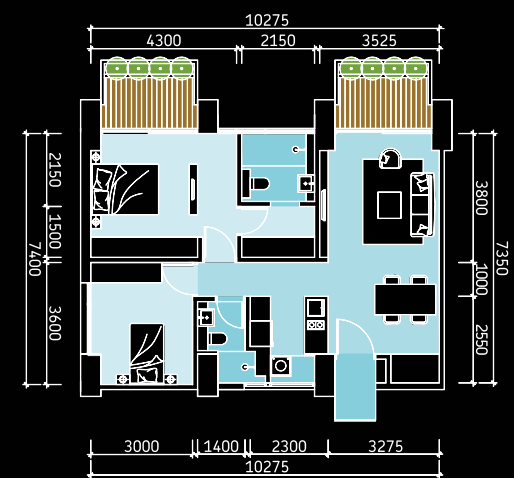

**UNIT TYPE A2**  
2 BEDROOMS • 979 SQ FT  
2 BAY BALCONY

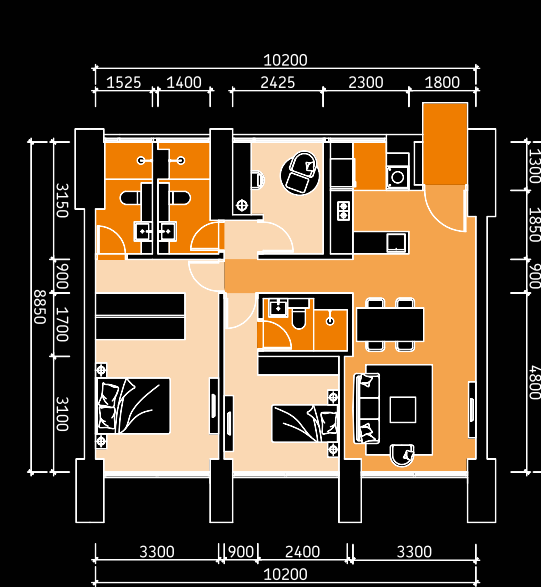

**UNIT TYPE B**  
2 BEDROOMS • 1,010 SQ FT  
NO BALCONY

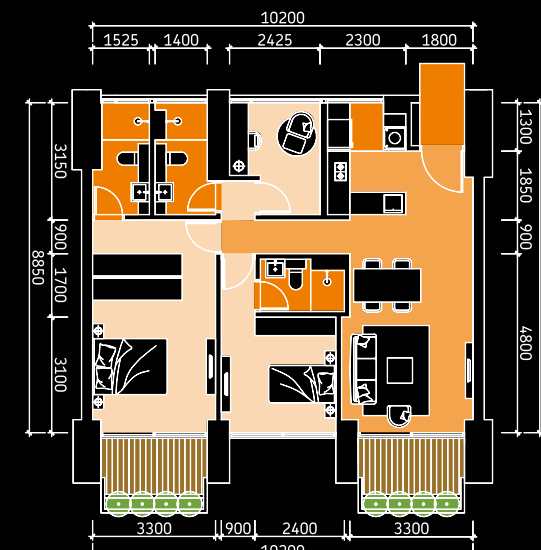

**UNIT TYPE B2**  
2 BEDROOMS • 1,159 SQ FT  
2 BAY BALCONY

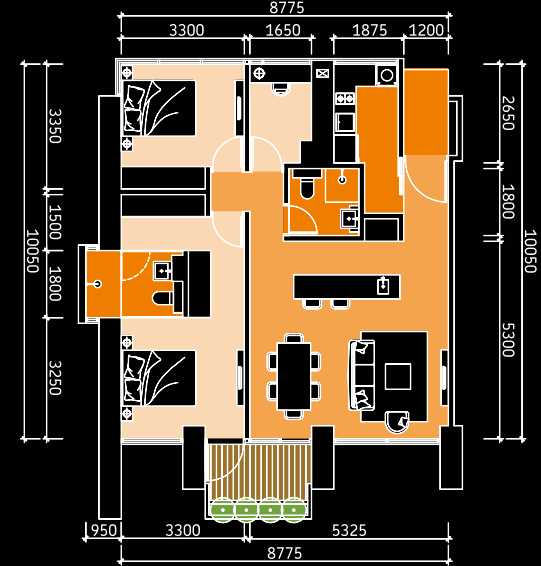

**UNIT TYPE B4**  
2 BEDROOMS • 1,084 SQ FT  
CORNER, 1 BAY BALCONY



**UNIT TYPE B1**  
2 BEDROOMS • 1,085 SQ FT  
1 BAY BALCONY



**UNIT TYPE B3**  
2 BEDROOMS • 1,009 SQ FT  
CORNER, NO BALCONY

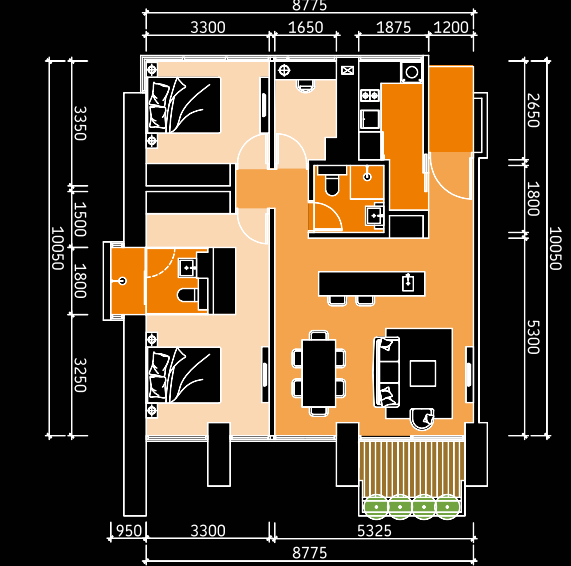

**UNIT TYPE B5**  
2 BEDROOMS • 1,084 SQ FT  
CORNER, 1 BAY BALCONY

# LIFESTYLE TOWER

# SWEET SPOT

Lumi Sales Gallery  
Location: PS2-15, Lumi Tropicana, No.2, Persiaran Tropicana, PJU 3,  
47410 Petaling Jaya, Selangor Darul Ehsan.  
www.lumicollections.com | 1700 81 8981 | ask@lumicollections.com | Waze: Lumi Tropicana

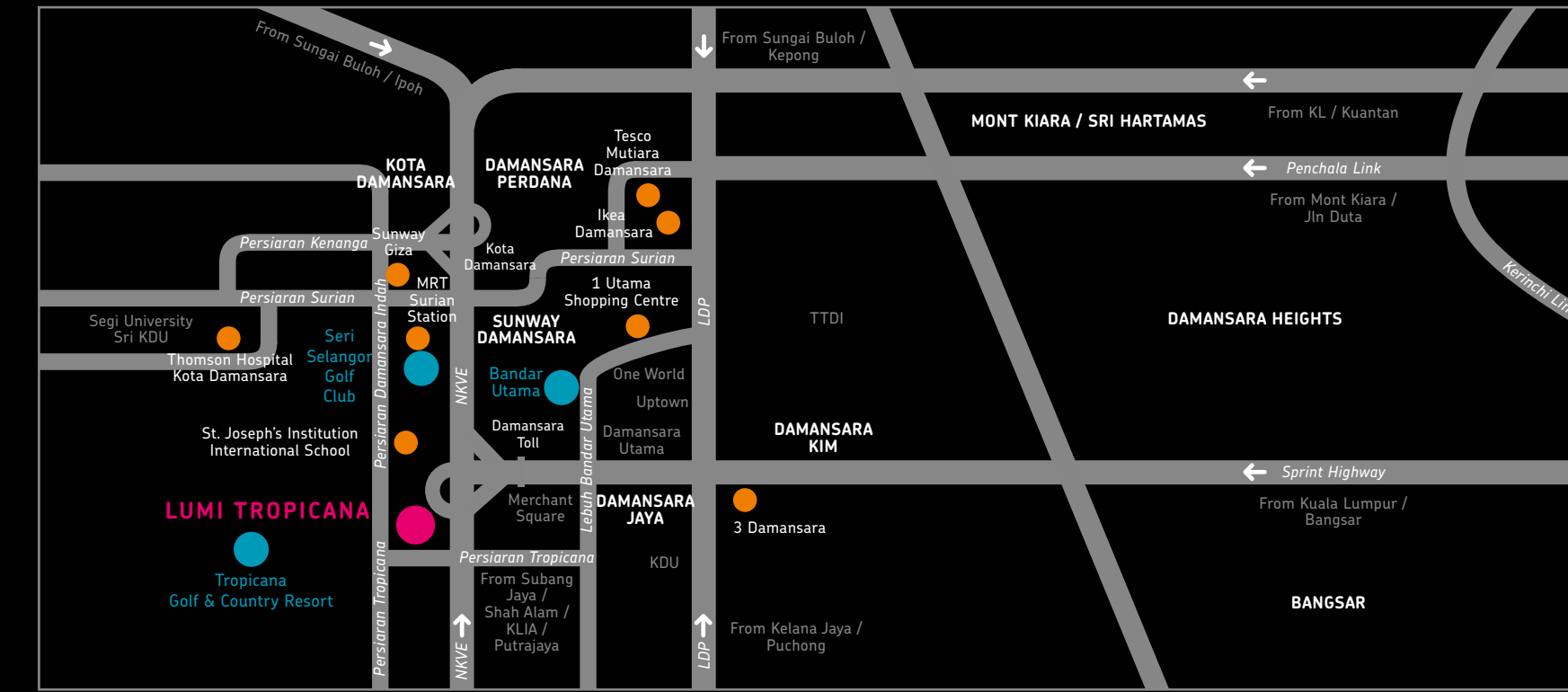

# MAKING THE BIG TIMES REALLY BIG!





## Apartments: all the right details in all the right places.

Lumi Tropicana offers a broad variety of floorplan choices—each created to provide a foundation for a different set of lifestyle needs. Each is designed to make the best possible use of space. With smart, meticulously planned layouts, they enable opportunity with every room, nook and corner. The Lifestyle Tower apartments are also designed to make the most of natural lighting and airflow. Big, extended windows generate an environment that's light-filled and airy, and as an added bonus, wonderfully showcase Tropicana's gorgeous vistas as well.

Some among us prefer to shape every element of their home environment themselves—carefully coordinating furniture and fittings, tailoring it to match their needs just so. For them, Thriven offers an entirely unfitted solution, complete only with tiles and ceilings. It's a blank canvas, ready for you to paint it as you wish. With time so often at a premium however, Lumi Tropicana also provides a solution for those who'd like to arrive at the door to their new home with a suitcase in hand and nothing more. Convenient and hassle-free, this option gives you a fully fitted, fully furnished home, beautifully decorated and expertly coordinated by award-winning Italian architect and interior designer, Marco Fumagalli.

There are several different configurations of colour, style and furnishing to choose from, allowing residents to select the interior design option that suits them best. Two of these options are currently on display at the Lumi sales gallery. One is light, airy, fresh and minimalistic. Striking in its simplicity, it presents an interior style that easily takes on the personality of the occupants, showcasing character and individual taste. It's also beautifully timeless. The purity of its design gives it an unquestionably contemporary atmosphere, but also a remarkable ability to maintain a fashionable look even among evershifting trends.

The other theme is darker, more strongly characterful. It features blues and greys and golds. There's brass and there's wood. Shades darker and lighter. There's a multitude of different tones and textures, creating a delightfully complex complimentary palette that's at once stylish and homely. Drawing inspiration from the past, but looking toward the future, the design is a re-envisioning of the bold 1920's art deco style—a beautifully sleek modern creation that welcomes in the twenties of a new century: the 2020's.

Developer: Myfair Sdn Bhd (60165095 - T) • Address: Level 23A, Megara LGS, Jalan Wan Kadir, Taman D. D. Megah, 40000 Kuala Lumpur, • Developer's License No. 14157 - 2/06 - 2022/02/26 (D) • Type of Property: Serviced Residences • Total Units: 372 • Selling Price: RM1,133,400,000 (RM) - RM 3,456,960.00 (Mal) • Built Up: 862 sq. ft. (Min) - 2,238 sq. ft. (Max) • Bumiputera Discount: 10% • Reservation in Interest: This land cannot be transferred, leased or charged without prior consent from State Authority • **IKLAN INI TELAH DILULUSKAN OLEH JABATAN PERUMAHAN NEGARA** • Disclaimer: The art, renderings and photographs contained in this circular are artist's impression only. The Developer reserves the right to modify any part or parts of the building prior to completion as directed or approved by the architects and/or the relevant authorities. All plans, layouts, information and specifications are subject to change and cannot form part of an offer or contract presentation.

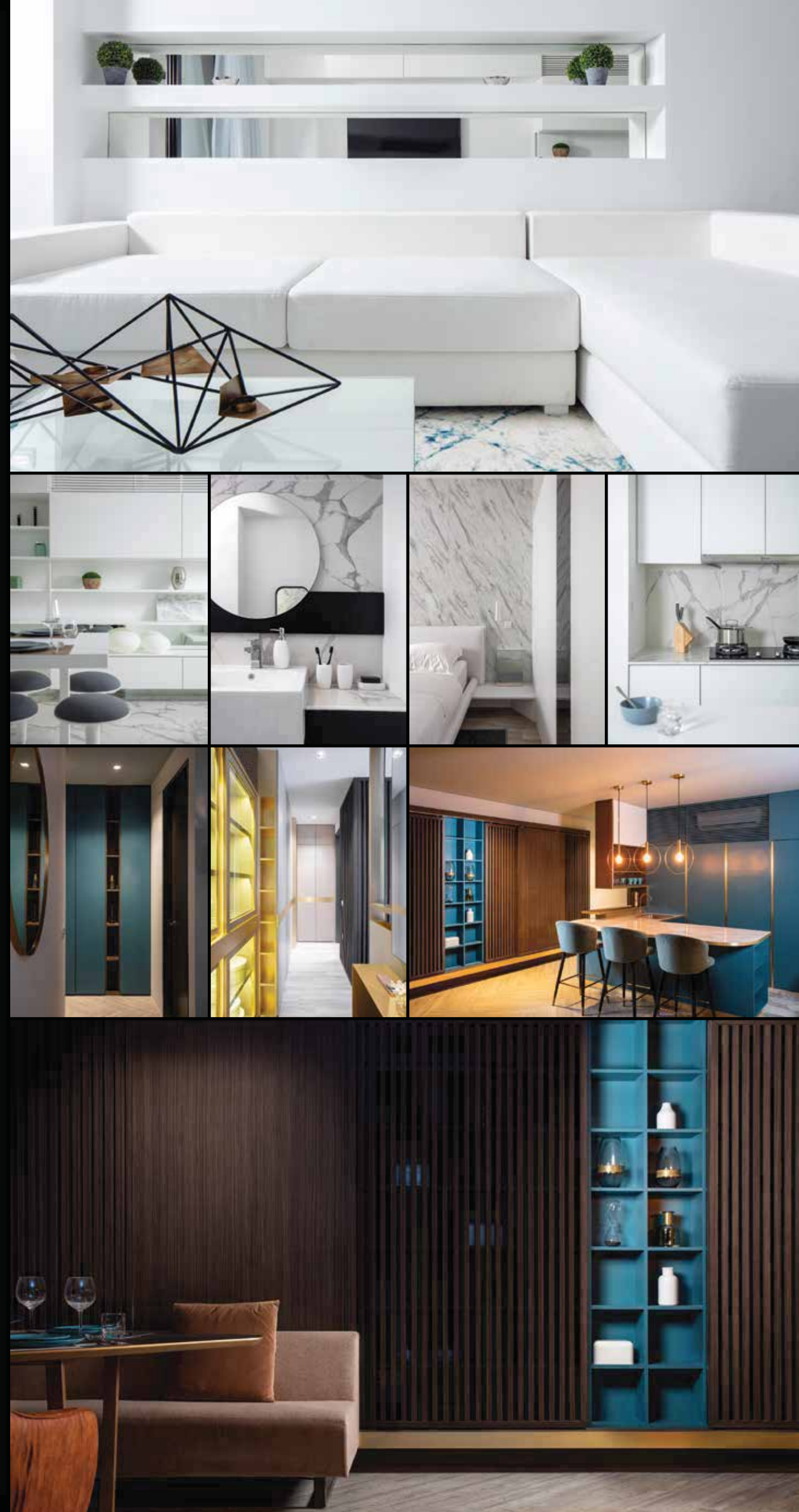

## Lifestyle Tower: get down to business with a home that works for you.

With Lumi Tropicana now entering its final stage of development, the last of its soaring quartet of towers is nearing completion. This is the Lifestyle Tower. Right at its heart, high up on the seventeenth floor, a sky terrace gazes out. Each of the four towers has one. Offering a range of facilities and amenities, the sky terraces are there to provide convenience and opportunity, each one aimed at helping you to free up time and create balance in a particular area of day to day life. The Lifestyle Tower takes on work life. It's perhaps one of the most challenging things in building a satisfying lifestyle. Work eats up so much of our day. The simple solution is of course just to work less. If only! Opportunities come when they will, and much of the time, work simply won't wait. We so often arrive home, finished for the day, when an urgent call comes in. There's one more thing to do. Another file. Another client. And so back to the office we have to go. The Lifestyle Tower presents an alternative.

Offering a broad selection of office and meeting facilities, lounges and seating areas, you've got a full-featured office environment right here at your own home. Grab a seat in the terrace's comfortable café-style working environment, enjoying a cup of freshly brewed as you squeeze in an extra few hours of work. Or perhaps you need a little more room. A desk. Office supplies and printing facilities. Just down the corridor, there's an informal office and co-working space. Available on demand, it's ideal for entrepreneurs, business owners, consultants, freelancers, those who frequently telecommute or anyone who just needs an office for the day.

The Lifestyle Tower has conference facilities too. There are two full meeting rooms right upstairs. The whole terrace is also fully catered, so when the agenda is finally cleared, you could invite your guests to join you for a meal. After, you might retire to the terrace's cigar lounge or wine room. Here you're able to settle back in a plush upholstered armchair, and indulge in an exquisitely flavoured Cohiba cigar or a buttery-smooth glass of single malt. Whatever facilities your working life demands, the Lifestyle Tower is your office in the sky.

## Lumi Tropicana: making sure each and every moment counts.

It's tough to build the lifestyle you truly want. There just never seems to be enough time to fit everything in. Balancing your work, family and health needs is a challenge, and then there's still your social life to consider too! Ultimately, lifestyles are about choices. Every moment you spend doing one thing, is a moment unavailable for doing anything else. This has been one of the guiding principles behind the development of Lumi.

Thriven builds real estate, but it's lifestyles we're truly creating. With each Lumi residence, our aim is to help you unlock more choices. Integrating a full range of facilities and amenities, Lumi homes present an opportunity to cut out the traffic, helping to save you time, and simultaneously offering you a host of new ways you could spend it instead. Lumi also provides a comprehensive hospitality service. Offering everything from housekeeping and laundry, to maintenance and a complete concierge and valet service, we help you to simplify and streamline—giving you back the hours of your day.

With Lumi Tropicana now entering its final phase of development, Lumi's debut is just around the corner. Situated at the heart of Petaling Jaya, Lumi Tropicana offers a glittering array of features. Curving all across the front of its long main podium, there's a record-breaking 190-metre-long infinity pool. And to the rear, an enormous elevated sports park. Home to a breath-taking array of sports and recreation facilities, the Lumi Park is a lush, green high-rise forest.

On the ground level, far below, there's the Lumi Marketplace. Incorporating 22,000 square feet of indoor space and a 34,000 square foot outdoor area, this long retail belt hosts restaurants, cafes, specialty stores and service providers. And, far above, high up in each of Lumi Tropicana's four soaring towers, there are four terraces. Providing a wide-ranging selection of recreation, relaxation and convenience-creating facilities, the sky terraces each house a set of amenities and facilities that together aim to help you enrich your lifestyle. They each focus on a particular aspect—the Play Tower, the Action Tower, the Wellness Tower, and the Lifestyle Tower.

